

# OLD 215 FRONTAGE AND ALESSANDRO BLVD.

Moreno Valley, CA

6 Building Business Park totaling ±198,824 SF  
5 Buildings Available For Sale or Lease



 **LEE &  
ASSOCIATES**  
COMMERCIAL REAL ESTATE SERVICES

Austin Hill  
SVP / Principal  
DRE # 01921364  
909.373.2732  
ahill@lee-assoc.com

Tyler Plata  
Senior Associate  
DRE # 02083579  
909.373.2948  
tplata@lee-assoc.com

Holden Edmondson  
Associate  
DRE # 02124931  
909.373.2916  
hedmondson@lee-assoc.com

 **PHELAN**  
DEVELOPMENT



# SITE PLAN



## PRICE: \$320

### BUILDING A - 13850 OLD 215 FRONTAGE RD



- 51,069 SF
- 30' Clear Height
- 3,073 SF of Two-Story Office
- 6 Dock High Doors
- 1 Ground Level Door
- 6 Trailer Parking Stalls
- 49 Car Parking Stalls
- Secured Yard
- 130 ft Truck Court
- ESFR K-25
- 800 Amps of Power

## PRICE: \$295

### BUILDING B - 13860 OLD 215 FRONTAGE RD

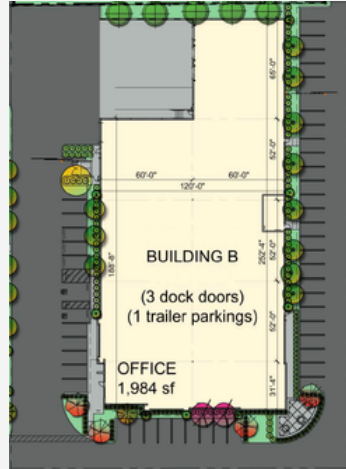

- 26,330 SF
  - 30' Clear Height
  - 1,984 SF Office\*
  - 3 Dock High Doors
  - 1 Ground Level Door
  - 3 Trailer Parking Stalls
  - 32 Car Parking Stalls
  - Private and Secured Yard
  - 123 ft Truck Court
  - ESFR K-25
  - 800 Amps of Power
- \*Possible Expansion, Additional 1,000 Sf Mezzanine

## PRICE: \$295

### BUILDING C - 13870 OLD 215 FRONTAGE RD

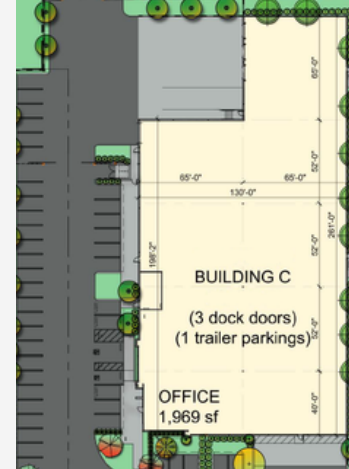

- 29,662 SF
  - 30' Clear Height
  - 1,969 SF Office\*
  - 3 Dock High Doors
  - 1 Ground Level Door
  - 3 Trailer Parking Stalls
  - 34 Car Parking Stalls
  - Private and Secured Yard
  - 120 ft Truck Court
  - ESFR K-25
  - 800 Amps of Power
- \*Possible Expansion, Additional 1,000 Sf Mezzanine

## PRICE: \$310

### BUILDING D - 13880 OLD 215 FRONTAGE RD

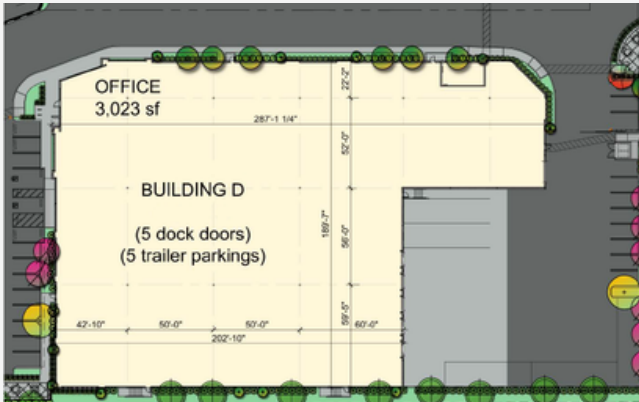

- 44,982 SF
- 30' clear height
- 3,023 SF Two-Story Office
- 5 Dock High Doors
- 1 Ground Level Door
- 5 Private Trailer Parking Stalls
- 47 Car Parking Stalls
- Private and Secured Yard
- 124 ft Truck Court
- ESFR K-25
- 800 Amps of Power

## PRICE: \$299

### BUILDING E - 13890 OLD 215 FRONTAGE RD



- 23,530 SF
  - 30' Clear Height
  - 1,988 SF Office\*
  - 3 Dock High Doors
  - 1 Ground Level Door
  - 3 Trailer Parking Stalls
  - 31 Car Parking Stalls
  - Private and Secured Yard
  - 130 ft Truck Court
  - ESFR K-25
  - 800 Amps of Power
- \*Possible Expansion, Additional 1,000 SF Mezzanine

## BUILDING A - 13850 OLD 215 FRONTAGE RD



- 51,069 SF

---

- 30' CLEAR HEIGHT

---

- 3,073 SF TWO-STORY OFFICE

---

- 6 DOCK HIGH DOORS

---

- 1 GROUND LEVEL DOOR

---

- 6 TRAILER PARKING STALLS

---

- 49 CAR PARKING STALLS

---

- SECURED YARD

---

- 130 FT TRUCK COURT

---

- ESFR K-25

---

- 800 AMPS OF POWER

---



## BUILDING B - 13860 OLD 215 FRONTAGE RD

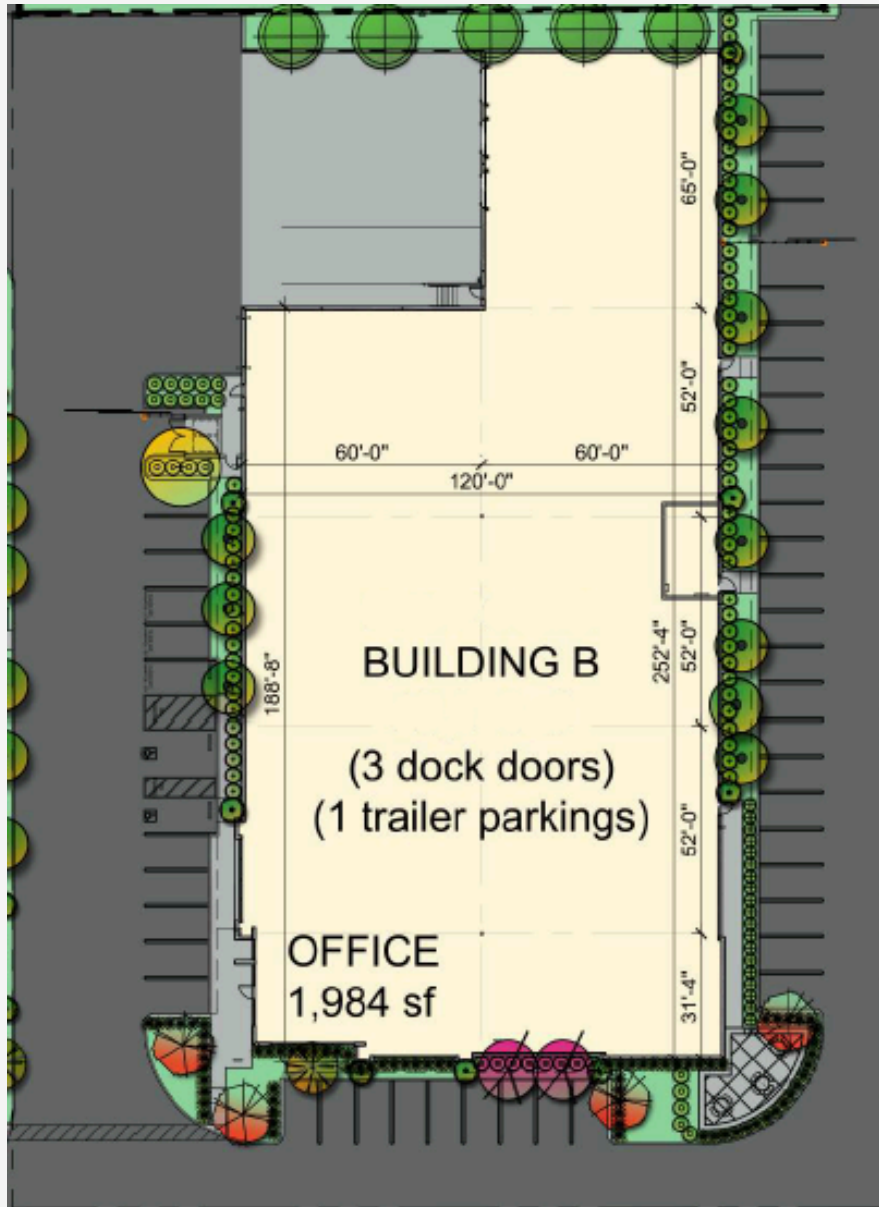

- 26,330 SF
- 30' CLEAR HEIGHT
- 1,984 SF OFFICE\*
- 3 DOCK HIGH DOORS
- 1 GROUND LEVEL DOOR
- 3 TRAILER PARKING STALLS
- 32 CAR PARKING STALLS
- PRIVATE AND SECURED YARD
- 123 FT TRUCK COURT
- ESFR K-25
- 800 AMPS OF POWER

\*POSSIBLE EXPANSION, ADDITIONAL 1,000 SF MEZZANINE

## BUILDING C - 13870 OLD 215 FRONTAGE RD

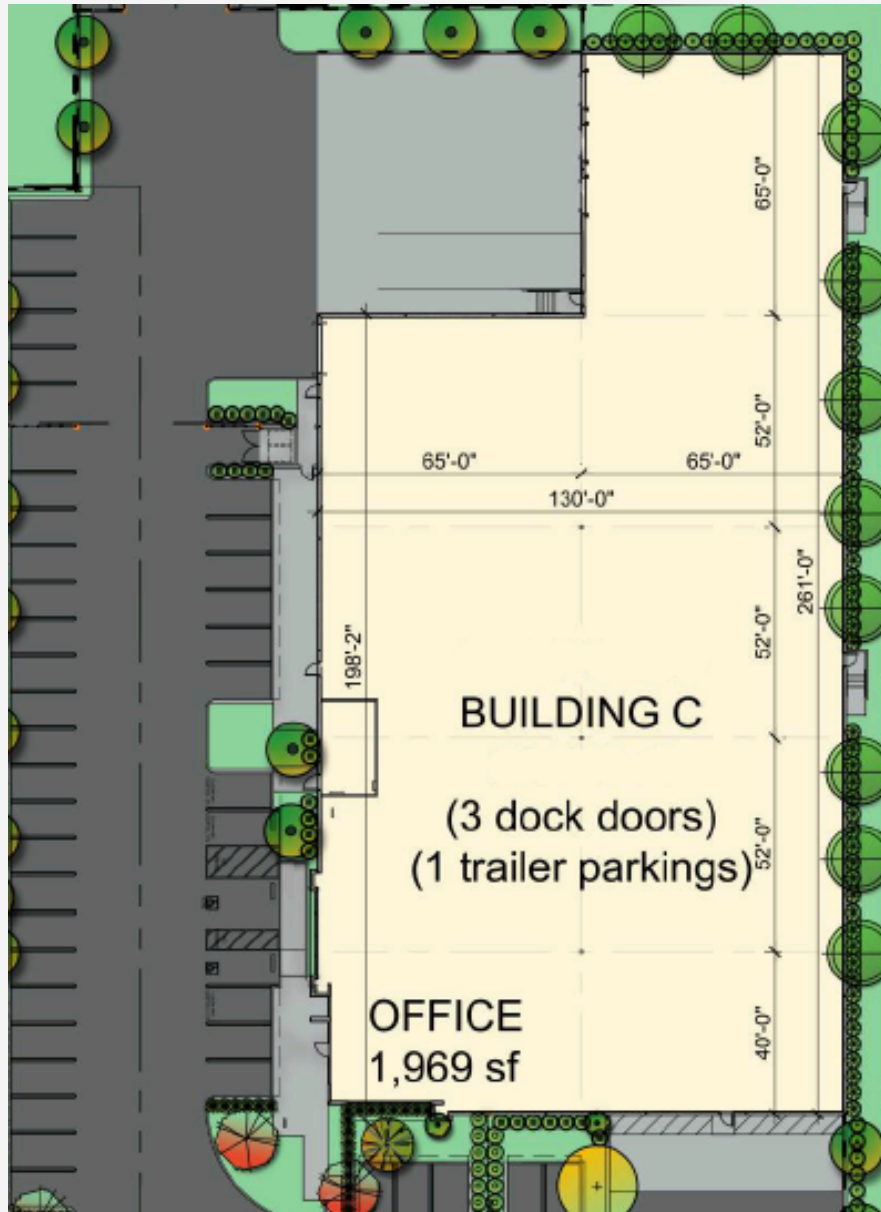

- 29,662 SF
- 30' CLEAR HEIGHT
- 1,969 SF OFFICE\*
- 3 DOCK HIGH DOORS
- 1 GROUND LEVEL DOOR
- 3 TRAILER PARKING STALLS
- 34 CAR PARKING STALLS
- PRIVATE AND SECURED YARD
- 120 FT TRUCK COURT
- ESR K-25
- 800 AMPS OF POWER

\*POSSIBLE EXPANSION, ADDITIONAL 1,000 SF MEZZANINE

## BUILDING D - 13880 OLD 215 FRONTAGE RD

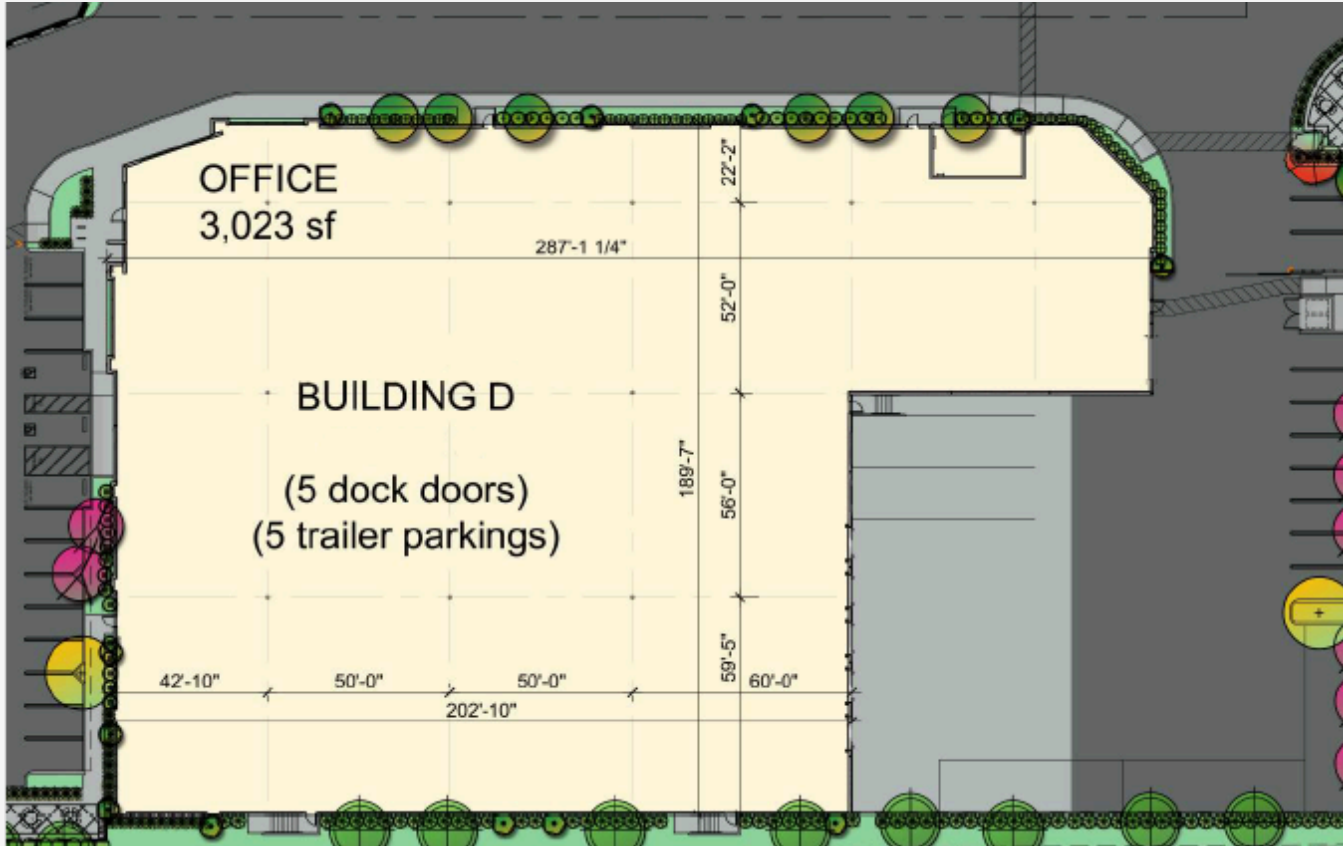

- 44,982 SF
- 30' CLEAR HEIGHT
- 3,023 SF TWO-STORY OFFICE
- 5 DOCK HIGH DOORS
- 1 GROUND LEVEL DOOR
- 5 PRIVATE TRAILER PARKING STALLS
- 47 CAR PARKING STALLS
- PRIVATE AND SECURED YARD
- 124 FT TRUCK COURT
- ESRF K-25
- 800 AMPS OF POWER

## BUILDING E - 13890 OLD 215 FRONTAGE RD

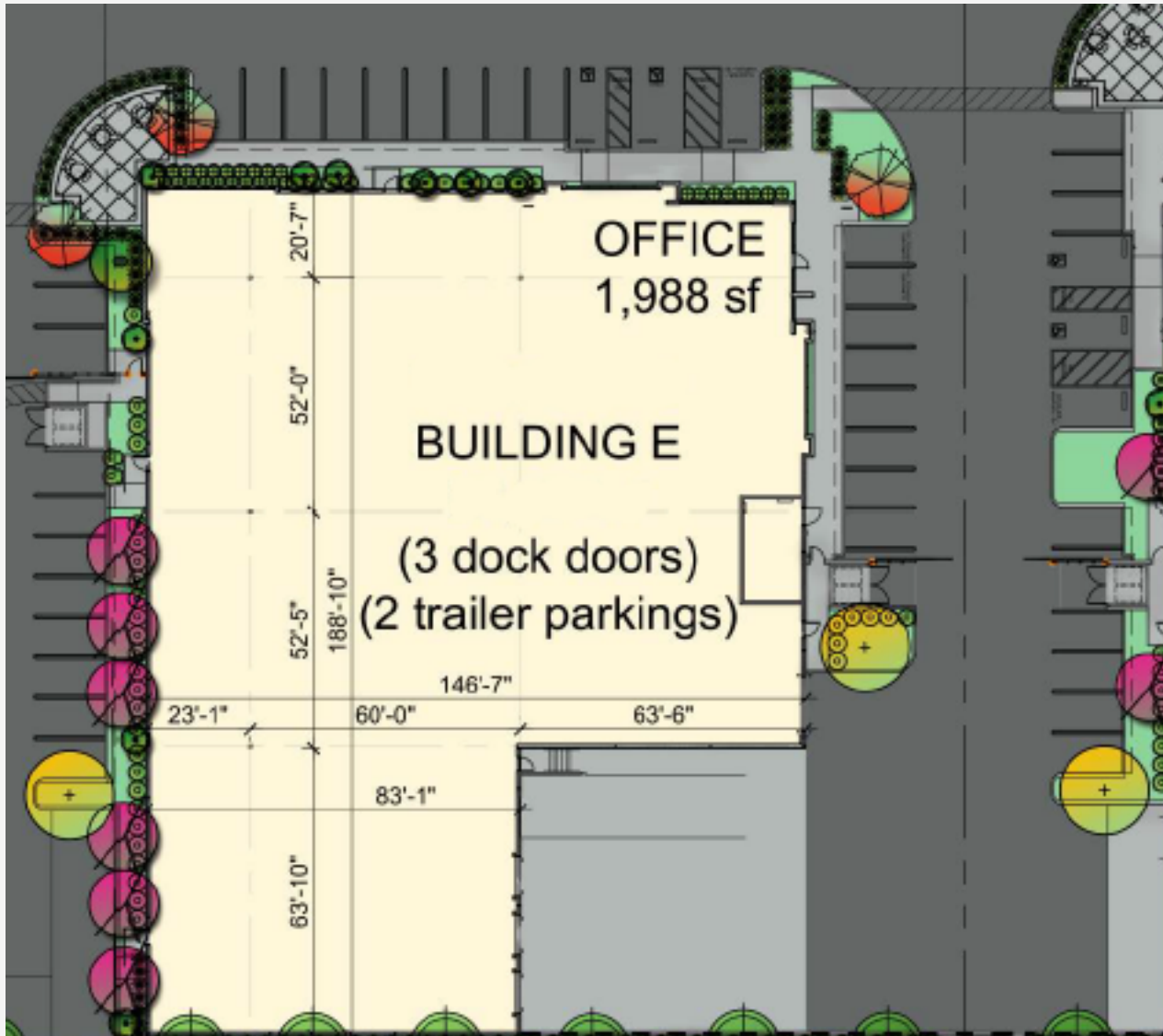

• 23,530 SF

• 30' CLEAR HEIGHT

• 1,988 SF OFFICE\*

• 3 DOCK HIGH DOORS

• 1 GROUND LEVEL DOOR

• 3 TRAILER PARKING STALLS

• 31 CAR PARKING STALLS

• PRIVATE AND SECURED YARD

• 130 FT TRUCK COURT

• ESFR K-25

• 800 AMPS OF POWER

\*POSSIBLE EXPANSION, ADDITIONAL 1,000 SF MEZZANINE



# LOCATION MAP

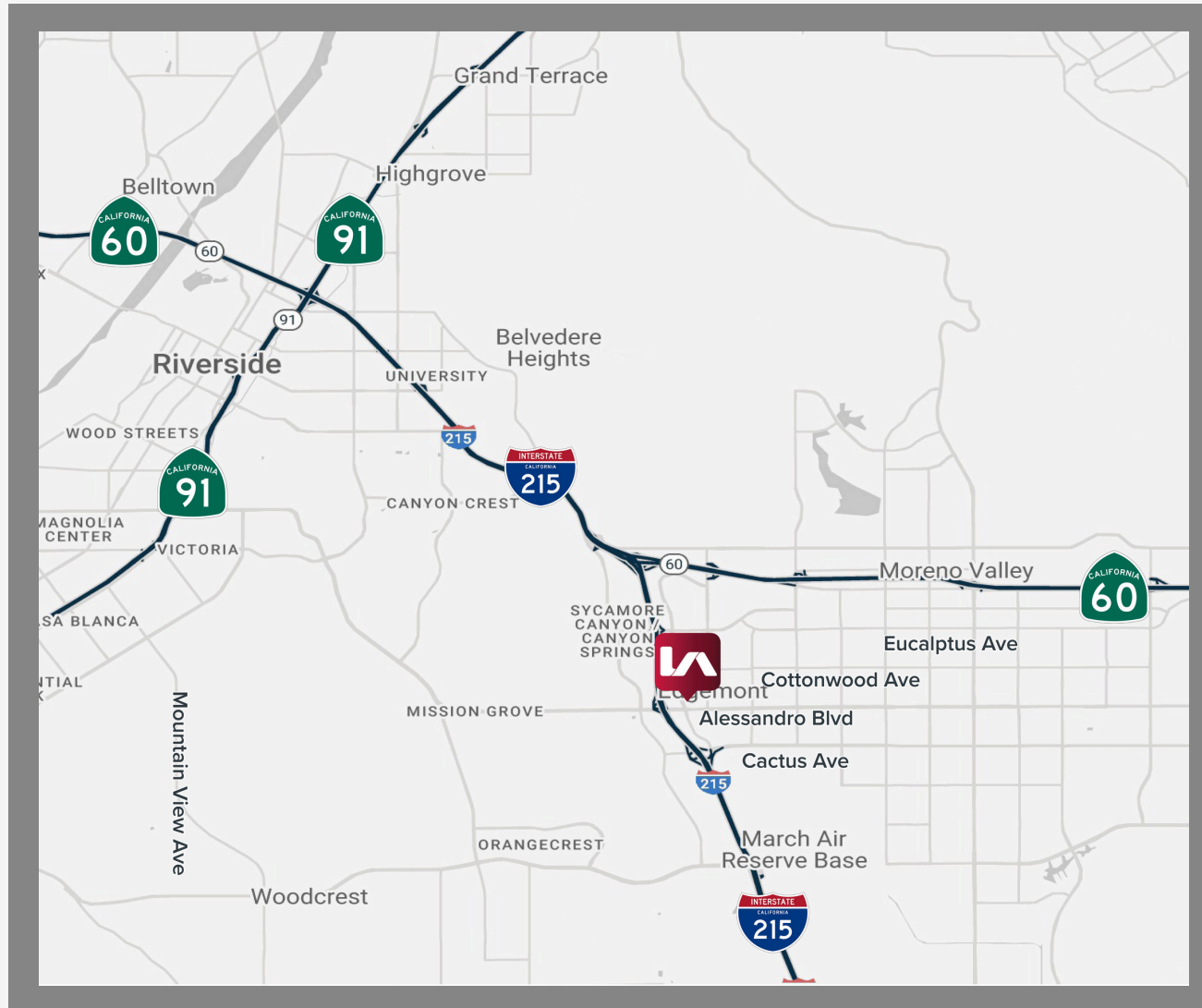

**23 MILES**

**ONTARIO INT'L  
AIRPORT**

**20 MILES**

**SAN BERNARDINO INT'L  
AIRPORT**

**69 MILES**

**PORTS OF LONG  
BEACH/LA**



# TENANT MAP

